

## Assembly of typical vacuum line system

To connect the vacuum bag to a vacuum pump, the components listed below should be used.

- (a) **Tygavac connector**
- (b) **Tygavac Valve**
- (c) **Tygavac Hose**

Individual Data Sheets will assist in the selection of the appropriate types.

A typical assembly procedure applicable to 125°C and 180°C cure cycles is as follows:

1. Connect **Tygavac Connector 440 or 440/1** to the vacuum bag film (see Data Sheet instructions).
2. Connect the plug of a **Tygavac 440 BF or 440 TF** to a Tygavac Connector. Apply PTFE thread seal tape or paste to the thread of Tygavac Connector and screw tightly into position to ensure an airtight seal.
3. (a) If using **Tygavac Hose 375C or 375CC**, apply PTFE thread seal tape or paste to the threaded hose fitting and screw tightly into the threaded female of **Tygavac Valve 440TF socket**, to ensure an airtight seal. connect the other end of the hose to the vacuum pump.  
  
(b) If using rubber hose, connect it to the barbed fitting of the socket of **Tygavac Valve 440BF**. Before connecting apply PTFE thread seal tape or paste to the male thread of the barbed fitting. Screw tightly into the female thread of the socket. Connect the other end of the hose to a vacuum pump.

The assembly is now ready for use. **Tygavac Valve 440BF or 440TF** enables the vacuum line to be disconnected quickly and easily and ensures that both sides of the line are automatically sealed by the valve when disconnected.

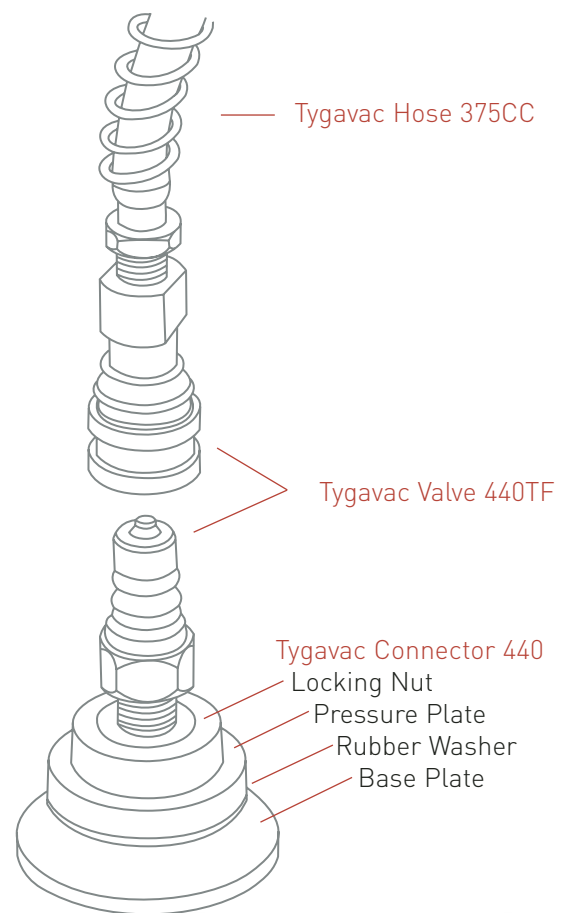

All statements, technical information and recommendations contained in this publication are based on tests believed to be reliable, but their accuracy and/or completeness are not guaranteed. The user shall determine the suitability of the product for his particular purpose and shall assume all risk and liability in connection therewith. All products are sold subject to Tygavac Advanced Materials standard Conditions of Sale.

**TYGAVAC**  
ADVANCED MATERIALS LTD

'Tygavac' is a registered trade mark.  
2002 - 7 - 9 - 2